

# Stage 16

## Specs

- 17,700 sq ft
- 158' x 112' x 28'
- 27' to the grid
- 2400 Amps
- 14' x 14' Elephant door
- 60-tons HVAC

## Features

- 8,000 sq ft of production offices
- 5,000 sq ft mill attached
- 2 loading docks
- WiFi throughout
- 24-hour security

## Key Notes

- 1) 1200 Amp power drops

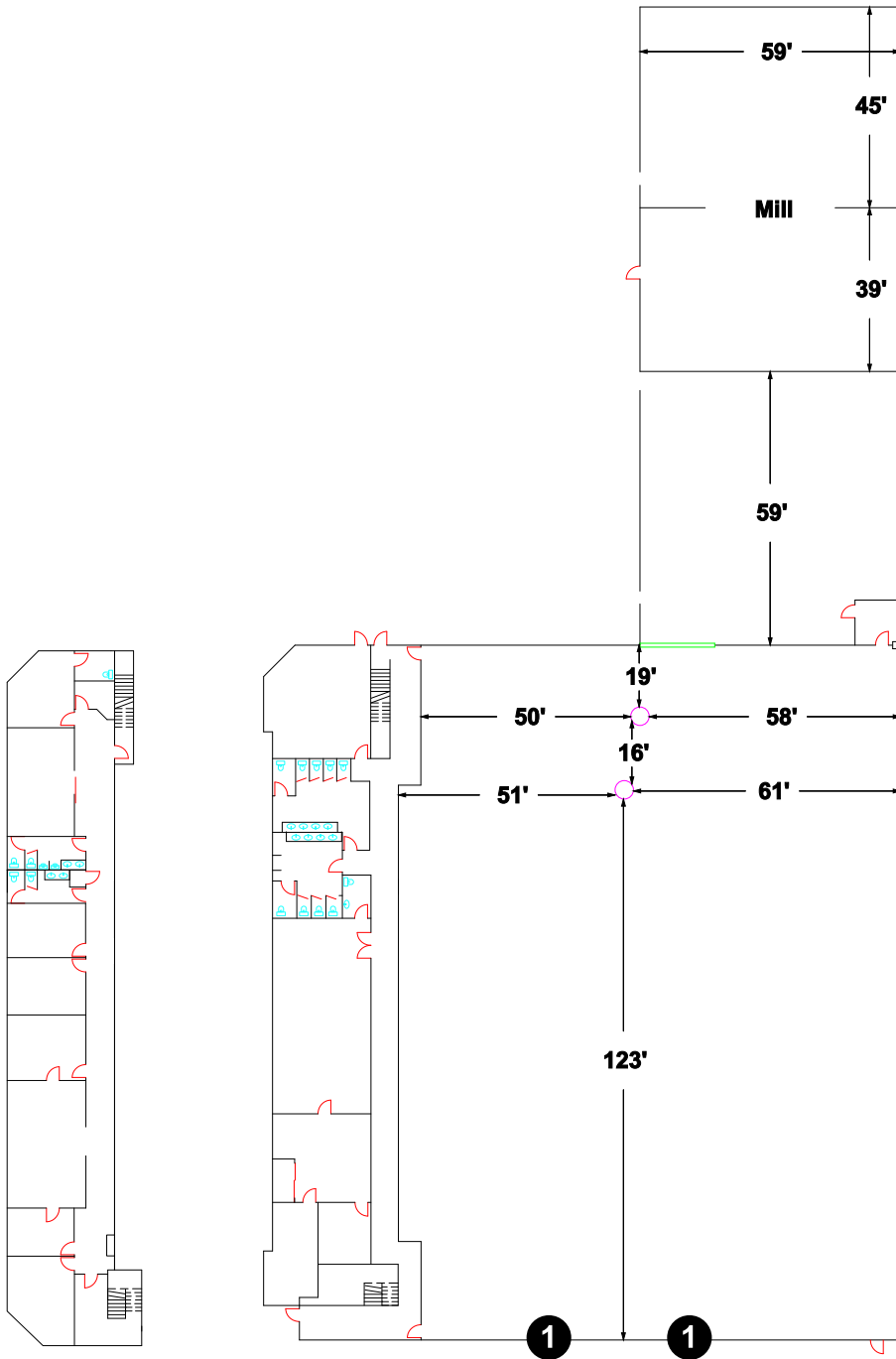

2nd Floor

1st Floor

