

Stage 9

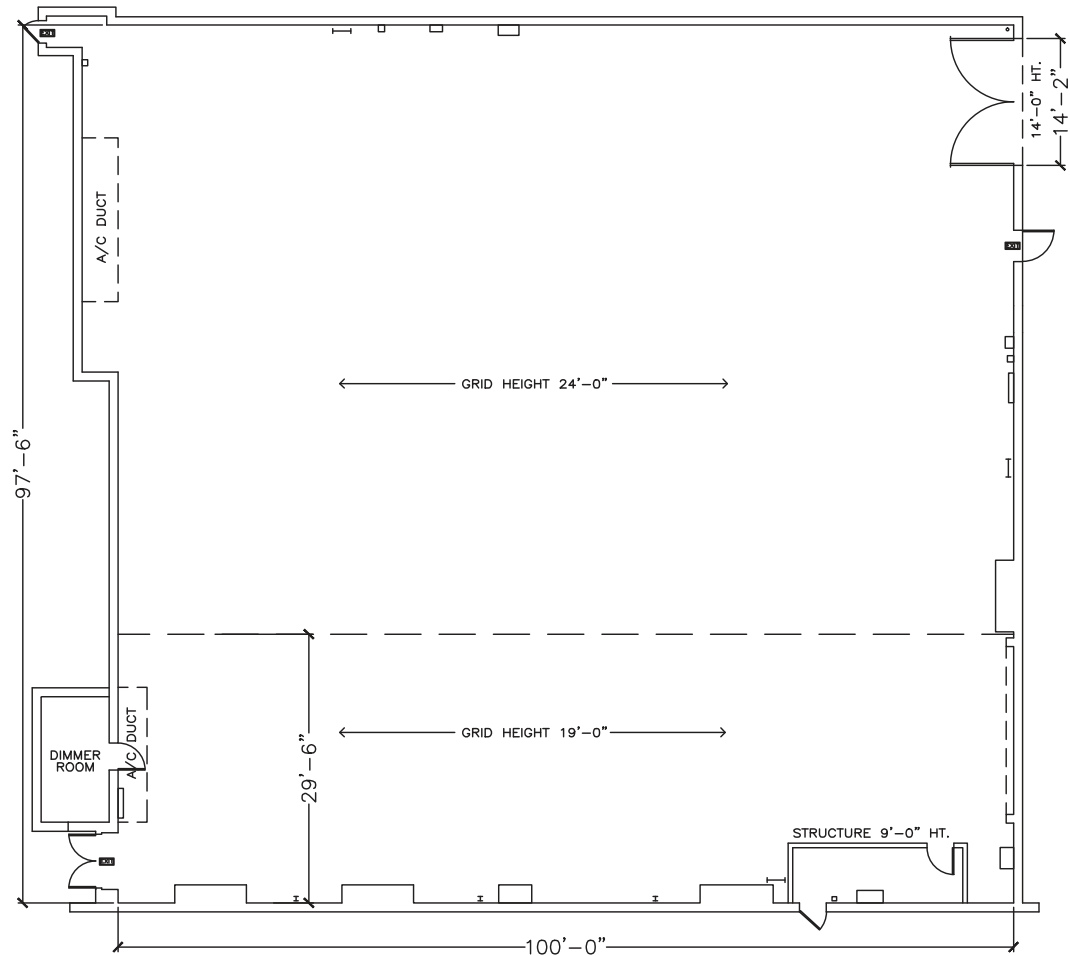

Width	Length	Height (Perms)	Total Stage Square Footage	Floor Type	Door (WxH)
99'	100'	24'6" & 19'	10,742	Wood	14'2" X 14'

Stage Specifications: Stage 9

Stage Specifications

Width – 99'
Length – 100'
Height (Perms) – Main: 24'6" Low: 19' See Diagram
Total Square Footage – 10,742 SF
Floor – Wood over slab
Elephant Door (W X H) – 14'2" X 14'

Additional Info

Audience Rated – 250 + crew
Drive-In – Yes
Cat Walks – Yes

Support Space

Control Room Connectivity – Yes; SMPTE fiber & audio break-outs/tech power
Dressing Rooms, Wardrobe, and Hair + Make Up rooms are available in adjacent buildings

Heavy Equipment

Stage Management to authorize

Electric Service

Production Power – 2 - switchable buss bars; 120/208 volt @ 3 phase 800 amps per phase 4800 amp total
240 Volts – No
480 Volts – No
Tech Power – Available

HVAC

80 tons
Redlight Control – Yes
Ventilation – Yes
Heating – No

Stage Extras

Hose Bib – Yes
Gas – Yes
Drain – No
Compressed Air – Yes
Wireless Internet – Available
Phone – Available
Fax – Available